



HISTORIC GUILDFORD - TOWN OF FIRST EUROPEAN SETTLEMENT 1829

THE GUILDFORD ASSOCIATION INC

ABORIGINAL LAND - ALWAYS WAS - ALWAYS WILL BE

P.O. Box 115 Guildford 6055 Western Australia 6055

ga@guildford.asn | www.guildford.asn.au | ABN 89 266 595 433

GUILDFORD MATTERS

GUILDFORD ASSOCIATION MEETING TUESDAY JUNE 20, 2023, 7.30PM

ST MATTHEWS' CHURCH HALL, STIRLING SQUARE, GUILDFORD

Mr John Viska, Chair of the Australian Garden History Society of WA, will present a talk on Ms Nancy Grasby, a past resident of Guildford and landscape architect from the early part of the 20th century. Nancy lived at 2 Turton Street and her father was prominent in the agricultural industry and wrote horticultural articles for the West Australian newspaper. Nancy was one of three noted women Landscape Architects from WA who made a successful career from garden design and landscape architecture.

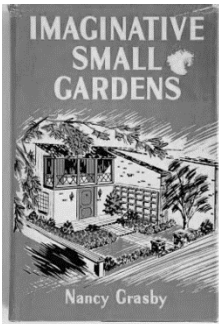

John will also have available some copies of the newly released book on Perth gardens, 'Historic Gardens of Perth European settlement to Modernism.' (\$50).

The free talk will be followed by supper and general meeting.

VAUDEVILLE THEATRE PLANS

The City of Swan has received a DA for the Vaudeville theatre in James St, Guildford. The final decision is with a Joint Development Assessment Panel (JDAP). The GA has parking and traffic concerns.

The licensees of the hotel are proposing expansion by linking the hotel and theatre and turning the theatre into a



tavern and beer garden. It is proposed to operate Sun to Thurs 11am - 10pm; Fri to Sat 11am-12am. There will be no onsite parking. The proponent estimates they will need 192 car bays which they say can be found in street parking within 200m of the building.

Note, the bays in the car park at the rear of the Guildford Hotel are for the hotel, as well as a retail development that will be delivered at a future stage.

The City of Swan's Design Review panel comments that "Lack of onsite parking in this context should not be seen as an issue - it is progressive thinking." The GA has concerns about the impact of such a large parking shortfall on surrounding streets and the primary school at pick-up time. The closing date for submissions is June 24. Go to Swan Engage on the City of Swan website to view the plans and comment, or email the planning officer in charge Jonathan.lendich@swan.wa.gov.au

STIRLING SQUARE FIRE PIT

The Guildford Association is pleased to note that following on from the Stirling Square implementation Committee and the completion of the Stirling Square Master Plan, there has been indigenous consultation and support for a final plan to embellish the existing fire pit. Due to commence in the 2023-24 financial year. See artist's impression.

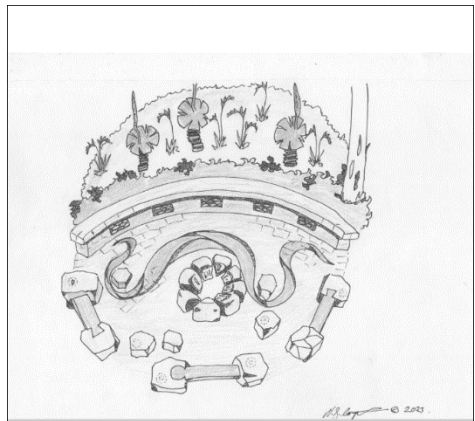

LIBRARY NEWS

A Justice of the Peace is available at Guildford Library on the first Saturday of the month, 12noon-2pm. This initiative has been arranged through FOGL (Friends of Guildford Library). You are welcome to pop along to a FOGL meeting, every third Wednesday of the month in the library at 11am.

Check Friends of Library on Facebook for news of school holidays activities and events at the library. And keep an eye out for a talk about quendas from Guildford local Dr Harriet Mills at Guildford Town Hall in July.

CITY OF SWAN SUPPORT FOR GA RECORDS

The Guildford Association Inc. is pleased to advise that the City of Swan have awarded \$5000 towards their Accessioning of Records Project. This project will see a qualified archivist work through past records and accession them into a format that will be acceptable for the Battye Library in Perth to receive them. It is important that these records, dating back to the 1970s, are available for public viewing. The Guildford Association was a leader in the heritage movement. These records acknowledge and recognise the need for protecting historic towns and places. In Guildford, the Association has fought to protect its unique town plan, buildings and built and natural environment for almost half a century - half a century of battles, discussion and debate. We thank the City of Swan for sponsoring this community driven project, which will provide important resource material and historical record for future generations.



WUTHERING DAY IN GUILDFORD

Get out a red dress, red lippy and your frosty green eye shadow and join in the most Wuthering Heights Day ever. Come along to Stirling Square Guildford on Sunday July 30 at 1.30pm and be part of a worldwide Kate Bush flash mob performing her Wuthering Heights dance. All money raised at the event through a gold coin donation, raffle and cupcake sale, will go to the nominated charity the Lung Foundation, Australia. This is in honour and memory of **Chris Cocozza**, a valued former executive member of the Guildford Association. The event is organised by local radio station 88.5FM. Plenty of parking is available at the train station car park. Guildford residents are encouraged to



walk to the event in their Kate finery.

GUILDFORD VERGE GARDENERS

The Guildford Verge Gardeners are hard at work now it is the planting season. Their efforts on the Fauntleroy Park verge have assisted in discouraging parking under the sugar gums, preventing root compaction and prolonging the life of the trees. Would you like to transform your front verge into a colourful native garden? Guildford Verge Gardeners can help. The City of Swan supports them with an allocation of tube stock. If interested, phone Pam on 9378 2523/0408 909 897.

AROUND TOWN

Guildford Family Playgroup - Twice weekly sessions during term time in St Matthew's Hall, Stirling Square, Guildford, on Monday January 30 and Wednesday February 1 from 9.30am-11.30am, both days.

Guildford Village Potters - Check out the current exhibition at Guildford Village Potters, 22 Meadow Street, Guildford. Gallery hours are 10am to 3pm week days and 10am to 4pm on weekends.

Swan Guildford Historical Society – Regular tours of the Colonial gaol and Taylor's Cottage and monthly speakers.

The Garrick Theatre – Coming up in July is heartbreaking gay love story *The York Realist*. Bookings www.TAZtix.com

The Association is constituted under the Associations Incorporation Act 1987 and operates under the requirements of that Act. **The Constitution can be viewed on the Association website:** <http://www.guildford.asn.au/>

Application for Membership

Membership is **\$20** per person, for the period September 1. 2022 to August 31.2023.

A membership form must be completed. Members are required to support the goals of the Association as stated in the Constitution. You can join up at our next meeting, or email ga@guildford.asn.au for a membership form.

**Newsletter kindly printed by Hon Michelle Roberts MLA,
Member for Midland**